



3-Axis Stabilized Handheld Gimbal

Compatible with GoPro HERO5 / HERO4 / HERO3+ / HERO3 /
Yi Cam 4K / AEE etc.

Product Overview

* The showing sports camera is only for reference

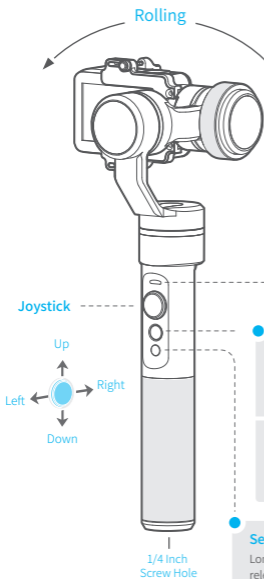

Indicator Status

Mode / Status

Blue light flashes once	Panning mode
Blue light flashes twice	Panning and Tilting mode
Blue light flashes for three times	Stand-by
Blue light constant on	Lock mode / Initializing
Blue light keeps flashing	Initialization failure / Malfunction
Red light flashes three times	Low battery
Red light keeps flashing	Entering stand-by / Entering power off

Function Button

You can use the function button to switch the working mode, power on or power off the gimbal. Please refer to chapter "Modes / Functions".

Power on: Long press Function Button and release it until the green light is on.

Power off: Long press Function Button and release it until the red light changes from quick flashing to constant.

Self-timer button

Long press the selfie button, the lens will rotate 180°, release to restore.

Water Splash Proof



App Control



Compatible with Accessories



*Never submerge the gimbal in water

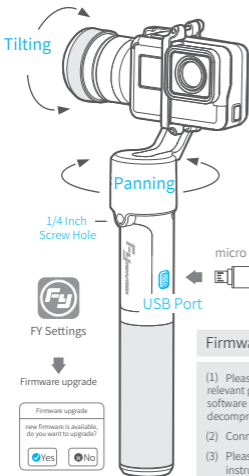

After power off, connect the USB cable to USB port, and connect with 5V USB power adapter (equipped by user) by USB cable .

The red indicator light is on during charging, and green light is on after the battery is fully charged.

Or take out the battery, and use the corresponding charger (equipped by user) to charge the battery .

Charging

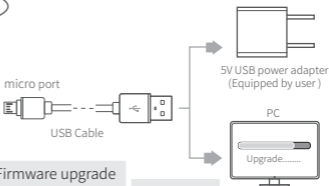

Firmware upgrade

- (1) Please visit the official website www.feiyu-tech.com to download the relevant programs for upgrading, including USB driver, firmware upgrade software and product firmware, and install the relevant software, decompress the firmware files for standby application.
- (2) Connect the USB cable with micro port as the above picture.
- (3) Please upgrade the relevant firmware according to the operation instructions of firmware upgrade software.

Or use the **FY Settings App** for firmware upgrades.

Connecting App

- (1) Please go to Apple app store to search "FY Settings" and then install it.

iOS version:



APP Store

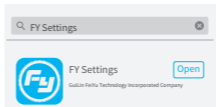

Android version:



scan to down load



Google play

- (2) Start the app on your smartphone, follow the instructions to connect the smartphone with gimbal via Bluetooth.

User Guide

Attention!

- (1) Please install the camera before powering on the gimbal
- (2) Please turn off the power when the gimbal is not in use, then remove the camera

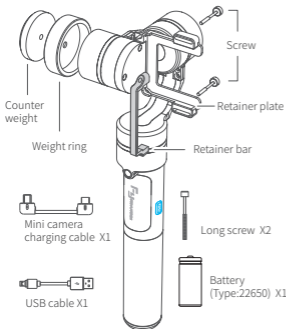

1 Install the battery

Remove the handle and insert one 22650 battery into it.



2 Install the Camera

Take the GoPro HERO 5 camera for example
Install the camera on retainer plate, then fix the camera with retainer bar and screw.

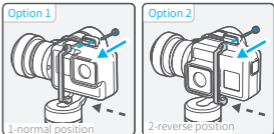

3 Camera balance adjustment

In order to achieve in a better performance of the gimbal, please try to balance the camera before power on G5.

Balance adjustment reference :

GoPro HERO 5 — counter weight & weight ring

GoPro HERO 4 — counter weight



Best Balance

Counter weight

Weight ring

3

4 Power on / off

Attention: Make sure the camera is secure before power on the Gimbal.

Power On: Press and hold function button until the green light is on.

Power Off: Press and hold function button until the red light changes from quick flashing to constant.



In case of low battery, the indicator will light red and flash 3 times every 5 seconds. Please charge G5 or replace the battery.

4

Modes / Functions

Working Modes

Panning Mode

Hold the tilting and rolling direction of camera lens, camera lens will move along with handle moving.

* The gimbal will work on Panning Mode after power on.

Panning and Tilting Mode

Hold the rolling direction of camera lens, camera lens will move along with handle moving.

Lock Mode

Hold the direction of camera lens.

Other Functions

Reset

Reset to power on status.

Stand-by

Shutdown all motors.

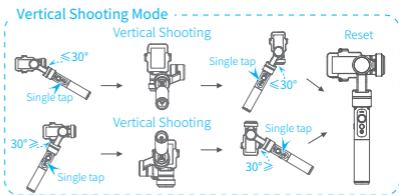

Mode / Function Operation Instructions

Function Button	Mode / Function	Explanation
Single tap	Panning Mode / Lock Mode	Single tap to switch between panning mode and lock mode
Double tap	Panning and Tilting Mode	Under panning and tilting mode, single tap to switch to lock mode
Triple tap	Rotate 180° in horizontal	Make the lens rotate 180°
Quadruple tap	Reset	Reset the tilting axis of the gimbal to initial orientation and initial mode
Long press until the red light flashes quickly	Stand-by	Under stand-by mode, you can wake up G5 by single tapping on function button or you can initialize G5 by triple tapping on function button

Gimbal initialization

You can initialize your gimbal when:

- (1) Camera is not level
- (2) Haven been used for long time
- (3) Big variation of ambient temperature

Adjusting steps:

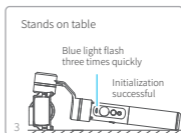
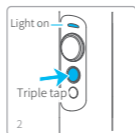
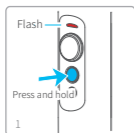

Parameters

Unit: mm

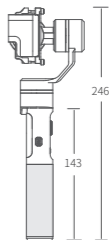
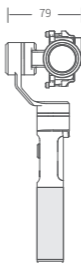
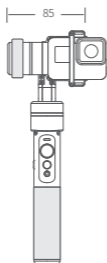
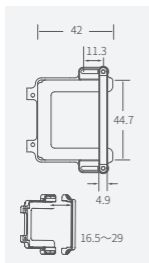

Titling Angle	360°	Titling Increments	min 2°/s max 75°/s
Rolling Angle	245°	Panning Increments	min 3°/s max 150°/s
Panning Angle	360°	Usage time	8 Hours
Adaption	GoPro HERO5 / HERO4 / HERO3+ / HERO3 / Yi cam 4K / AEE		and other cameras with the same size
Weight	271g (Not including battery, camera or counter weight)		

Charging for Camera



By connecting the camera (equipped with Mini-USB charging port) and G5, the camera can be charged while G5 is power on.

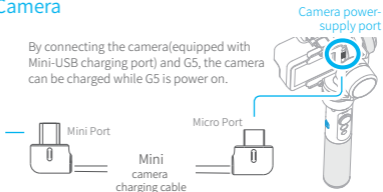

Audio effect optimization

When installing GoPro HERO5 on G5, the following configuration of HERO5 will help you to get better audio effect:

[RAW AUDIO TRACK] HIGH

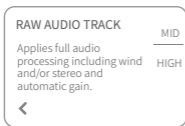

[MANUAL AUDIO CONTROL] Wind Only

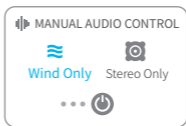

DISCLAIMER

Prohibit any user for any illegal purpose. Users will be responsible for all behaviors of purchase and use products.

The Company assumes no liability for any risks related to or resulting from the debug and use of this product (including the direct, indirect or third-party losses).

For any unknown sources of using, we will not be at any services.

The updating and changes of product firmware and program may cause changes in function descriptions in this user manual, please read the instructions carefully before upgrading the firmware and use the corresponding user manual.

You can get the latest user manual from the official website: www.feiyu-tech.com

Feiyu Tech reserves the right to amend this manual and the terms and conditions of use the product at any time.

Attention

- Please correctly assemble the gimbal in accordance with the diagram
- Please install the camera before powering on the gimbal
- When the gimbal is not in use or placed on the table, please ensure it is powered off



Create More Possibilities

For more information, please visit our official website: www.feiyu-tech.com
Support Email: service@feiyu-tech.com

This product is due to follow-up hardware and software updates may occur
description of the introduction does not match the actual product features.
You can get the latest user manual from the official website



www.feiyu-tech.com